

ALLURE
Thermostatic shower mixer 1/2"
MODEL # 19304

Pure Freude an Wasser

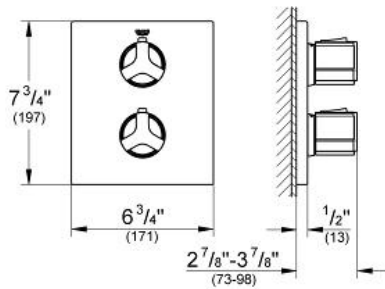

GROHE America, Inc | 200 North Gary Avenue, Suite G, Roselle, IL 60172
Phone: +1 (800) 444-7643 | Fax: +1 (800) 225-2778 | us-customerservice@grohe.com



Product Description:
Thermostatic shower mixer 1/2"

Standard Specification:

- GROHE StarLight® finish
- For use with GROHTHERM Rough-In Valve 34 126

Applicable Codes & Standards:

- Energy Policy Act of 1992
- ASME A112.18.1/CSA B125.1

Color:

- 19304 000 chrome
- 19304 EN0 brushed nickel